

RANCHO SANTA FE PROTECTIVE COVENANT SETBACK REQUIREMENTS

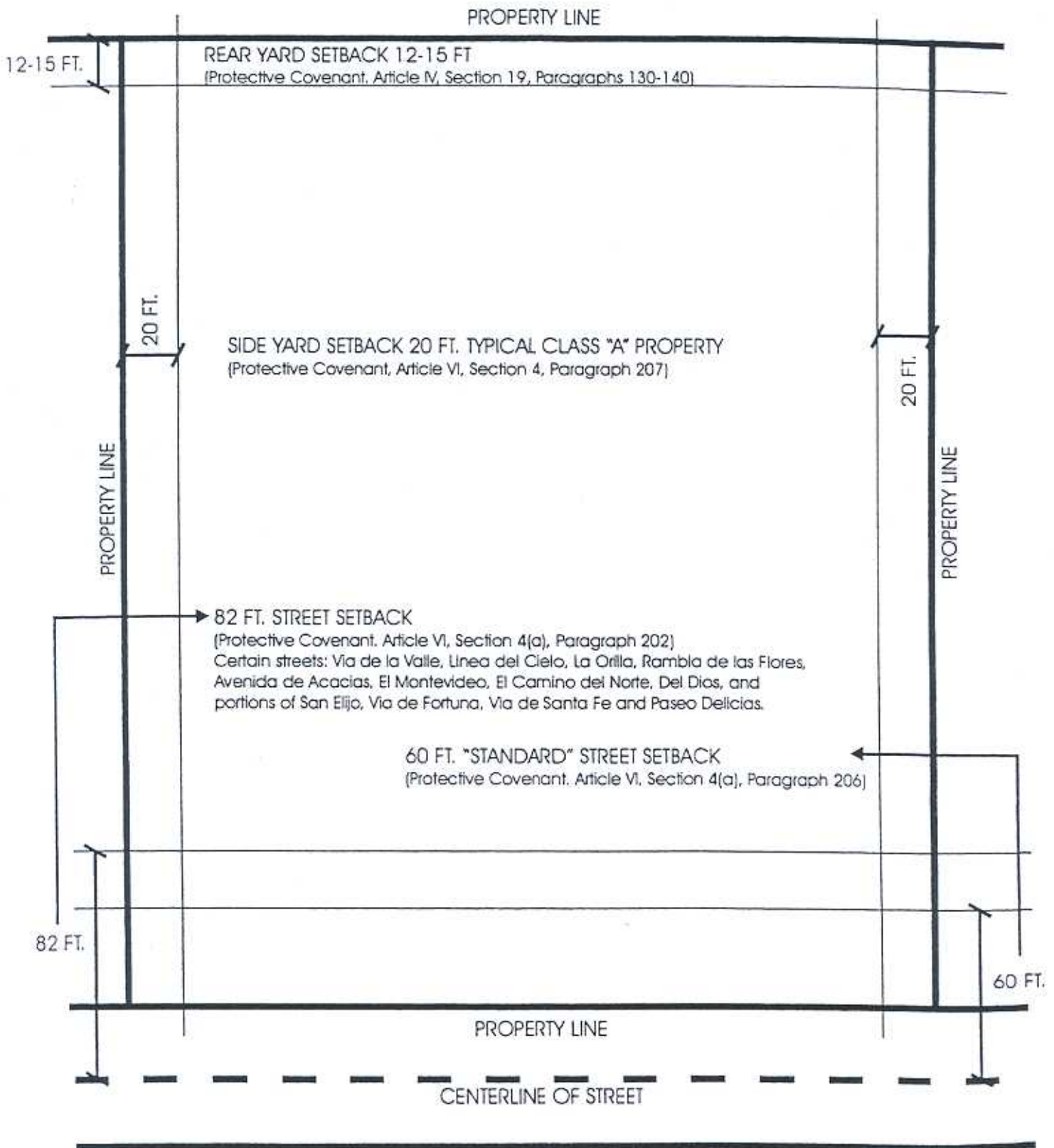

NOTES:

This is a diagram showing typical setbacks. For exact requirements, always refer to the Protective Covenant. For accessory buildings, please refer to the Protective Covenant, Article IV, Section 14, Paragraphs 111-120. County of San Diego setbacks differ from Covenant setbacks. Both standards must be complied with.